

BUILDER TO DISCUSS NOTE 50,  
 IN DETAIL WITH CLIENTS.

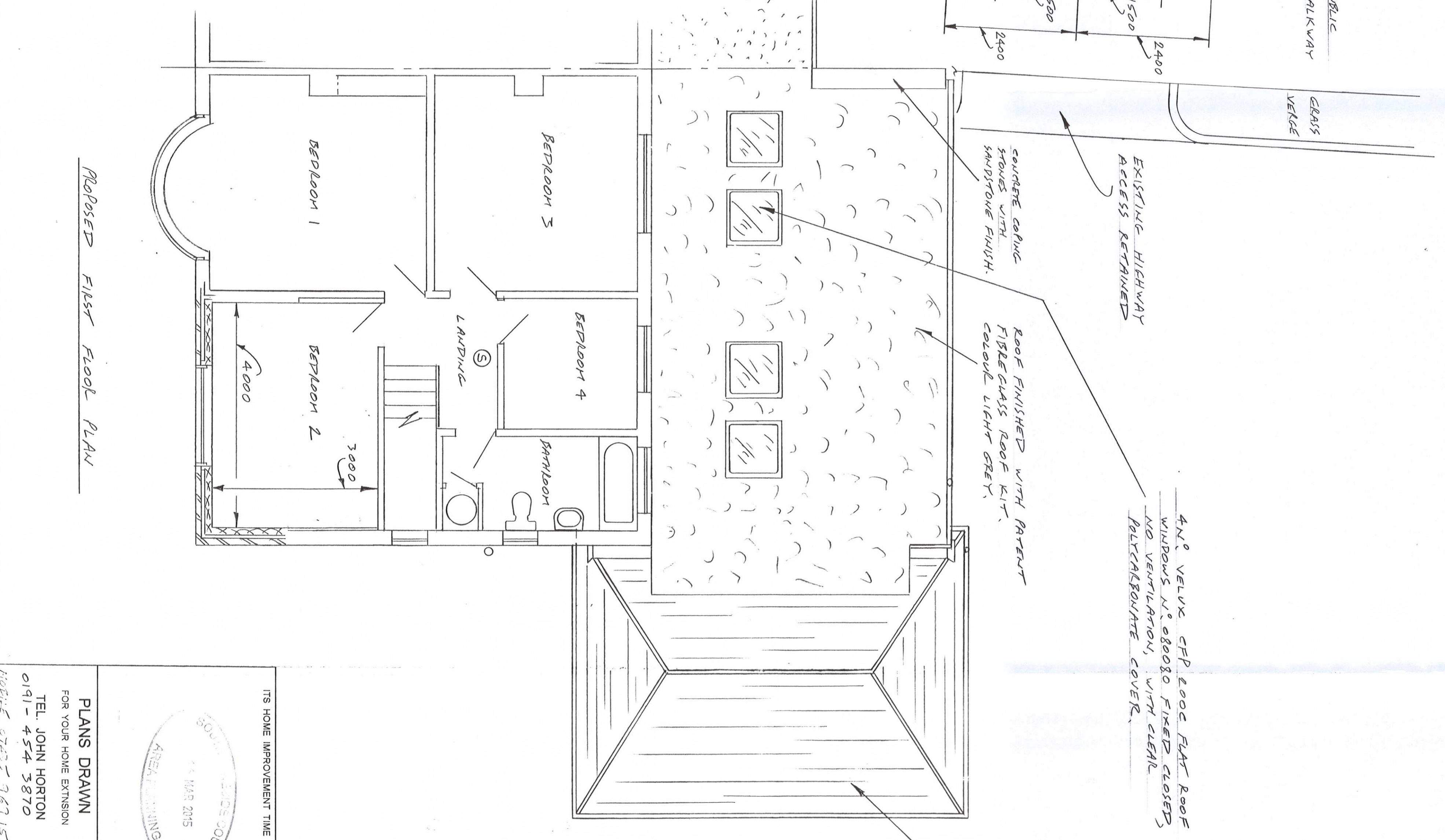

4" x 6" VELUX CFP 600C FLAT ROOF  
 WINDOWS N° 080080 FIXED CLOSED,  
 NO VENTILATION, WITH CLEAR  
 POLYCARBONATE COVER.

ROOF FINISHED WITH PRESENT  
 FIBREGLASS ROOF KIT.  
 COLOUR LIGHT GREY.

ROOF FINISHED WITH  
 CAST CONC. TILES CAREFULLY  
 MATCHED WITH EXISTING.

**AMENDED**  
 ST/00SS/1/S JK/CL  
**PLAN**

REVISION 'A' DATE 12-3-2015  
 GARAGE RE-POSITIONED AND  
 REDUCED IN SIZE.



PLANS DRAWN FOR YOUR HOME EXTENSION		DRAWING TITLE <b>PROPOSED FLOOR PLANS</b>	
DATE 18-12-2014	SCALE 1:50	DRAWING NUMBER 2014-171	SHEET 4 OF 9 SHEETS REVISION 'A'
CLIENT MR. D. JEFFELS		ADDRESS 28 THE BROADWAY SOUTH SHIELDS NE33 3NH	
JOB TITLE PROPOSED DOUBLE STABLE FRONT GARAGE, FRONT, SIDE AND REAR BOUDBLY WALLS.		CONTRACTOR ITS HOME IMPROVEMENT TIME	
TEL. JOHN HORTON 0191-4574 3870		REVISION 'A'	
MOBILE 07427 767151			